

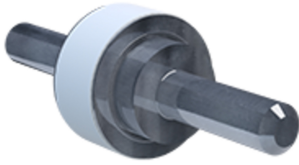

CITEL

Isolating spark gap (ISG)

BF P100 500/20



- › Isolating spark gap
- › Outdoor application
- › Max. discharge current: 100 kA
- › EN 62561-3 compliance

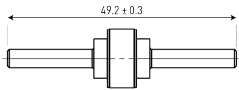

Electrical Characteristics

| | | |
|--|---------------------|--------|
| Rated DC withstand voltage | Uw DC | 400 V |
| Rated AC withstand voltage | Uw AC | 280 V |
| Max. discharge current <i>max. withstand @ 8/20 μs by pole</i> | I _{max} | 100 kA |
| Impulse current by pole <i>max. withstand 10/350 μs by pole</i> | I _{imp} | 50 kA |
| Classification following IEC 62561-3 | | N |
| Rated impulse sparkover voltage <i>1kV/μs</i> | U _{r limp} | 1200 V |

Mechanical Characteristics

| | | |
|-----------------------------------|----------------|------------------------|
| Technology | | Gas discharge tube |
| Operating temperature | T _u | -40/+85°C |
| Operating and storage temperature | | -40°C / +90°C |
| Protection rating | | IP67 |
| Number of units per package | | 20 units per cardboard |
| Dimensions | | Ø 16mm |

Standards

| | | |
|----------------------|--|------------|
| Standards compliance | | EN 62561-3 |
| RohS compliance | | Yes |

Part number

90231322

