



'Quarter wave' coaxial protector

CITEL

PRC822S-716W/FF



- 'Quarter wave' coaxial protector type 7/16
- Frequency : 800-2200 MHz
- Low insertion loss
- I_{max} > 50 kA
- Maintenance free
- Bi-directional
- IP65

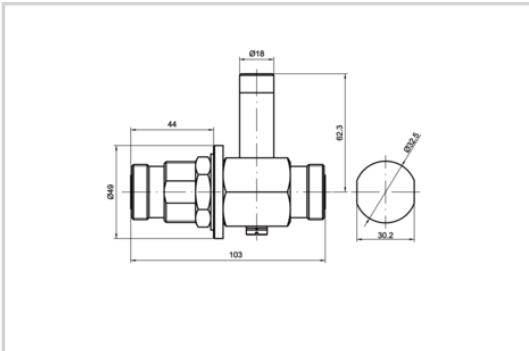

| Electrical Characteristics | | |
|---|------------------|-------------------------------------|
| Frequency range | f | 800-2200 MHz |
| Insertion loss | | < 0.2 dB |
| Return loss | | > 20 dB |
| Impedance | | 50 ohms |
| VSWR | | <1.2:1 |
| Max. load current @25°C | IL | 10 A |
| Max. discharge current max. withstand @ 8/20 µs by pole | I _{max} | 100 kA |
| Protection mode(s) | | Common mode |
| Protection level @ I _n (8/20µs) | Up | < 30 V |
| Impulse current 2 x 10/350µs Test - D1 Category | I _{imp} | 50 kA |
| Nominal discharge current C2 Category | I _n | 50 kA |
| Max Power @f max. | | 1785 W |
| Max Power @f mini. | | 2959 W |
| PIM 3rd order (2x20W) | | < -160 dBc |
| DC Pass | | No |
| Mechanical Characteristics | | |
| Technology | | Quarter Wave |
| Connection to Network | | Connector 7/16 Female/Female |
| Mounting | | Feedthrough |
| Housing material | | Brass/Surface plating: Cu Zn Sn |
| Operating temperature | T _u | -40/+85°C |
| Protection rating | | IP65 |
| Failsafe mode | | Without |
| Dimensions | | See diagram |
| Contacts | | Bronze/Surface Au-Ag |
| Standards | | |
| Standards compliance | | IEC 61643-21 / EN 61643-21 / UL497E |
| RohS compliance | | Yes |
| Part number | | |
| 621105 | | |

